

8" KPAK[®] Modules

Zero Bypass Ultrafiltration Modules for Electrocoat Paint

PRODUCT DESCRIPTION

Membrane Chemistry:	PVDF
Membrane Type:	HFM -183 (Positive Charge)
Construction:	Spiral wound element with integrated PVC housing
Seal:	EPDM

NOMINAL SPECIFICATIONS

Part Number	Model	Feed Spacer mil (mm)	Membrane Area ft ² (m ²)
0750785	KPAK 8638-M183-LPP	30 (0.8)	288 (26.7)
0750786	KPAK 8638-M183-VPP	46 (1.2)	241 (22.4)

OPERATING AND DESIGN INFORMATION*

Maximum Inlet Pressure at Temperature:	80.0 psi @ 110 °F (5.5 bar @ 43 °C)
Maximum Inlet Pressure at Temperature:	64.0 psi @ 120 °F (4.4 bar @ 49 °C)
Minimum Outlet Pressure:	10.0 psi (0.70 bar)
Maximum Operating Temperature at Pressure:	125 °F @ 56 psi (51.6 °C @ 3.9 bar)
Maximum Permeate Side Back Pressure:	5.0 psi (0.34 bar)
Maximum Feed Side Pressure Drop:	35.0 psi @ 125° F (2.4 bar @ 51.6 °C)
Allowable pH – Continuous Exposure:	2.0 - 10.0 pH @ 125 °F (51.6 °C)
Allowable pH – Short Term Exposure:	1.5 - 10.5 pH @ 125 °F (51.6 °C)

*Koch Separation Solutions, Inc. must review operating and cleaning conditions for all new plants and any changes to existing plants

NOMINAL DIMENSIONS

Pressure Drop		Circulation Flow (30 mil)		Circulation Flow (46 mil)	
psi	bar	gpm	m ³ /hr	gpm	m ³ /hr
25	1.7	62	14.1	97	21.6
30	2.1	70	15.9	109	24.3
35	2.4	75	17.0	117	26.1

*Data are based on water @ 77 ° F and a specific gravity of 1.0. Circulation rates exhibit variances of + 15%.

OPERATING AND DESIGN INFORMATION*

Element Length:	39.25 in (997.0 mm)
Element O.D.:	8.63 in (219.2 mm)
Permeate Tube I.D.:	1.3 in (33.0 mm)
Element Shipping Weight:	70 lbs (32 kg)
Element Working Weight:	90 lbs (40.82 kg)

8" KPAK® SPIRAL MODULE ASSEMBLY

PART LIST

Item	Description	Material	KPN	Req'd
1	Outlet End Cap	304 SS	1005176	1
2	Inlet End Cap	304 SS	1005175	1
3	Permeate O-Ring	EPDM	1006103	4
4	8" Coupling	Steel	1001123	2
5	8" Gasket	EPDM	Comes w/#4	2
6	Permeate Plug	PVC	1005183	2
7a	2" Coupling	Steel/EPDM	0151258	2
7b	2" x 1½" Coupling	Steel/EPDM	1004333	2
For Retrofit Only:				
8	Cartridge Support	304 SS	0030363	1
9	Hardware ¾"-16UNC	304 SS	0211865	1

Kit for New Systems

Part number KPN 0211860

Retrofit Kit with 2" Process Ports

Part number KPN 0211851

Retrofit Kit with 1½" Process Ports

Part number KPN 0211858

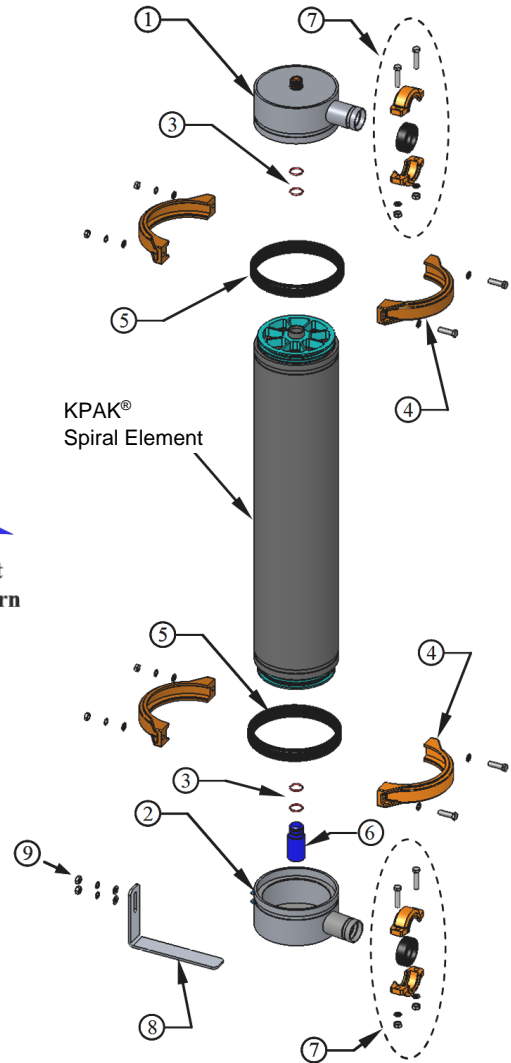
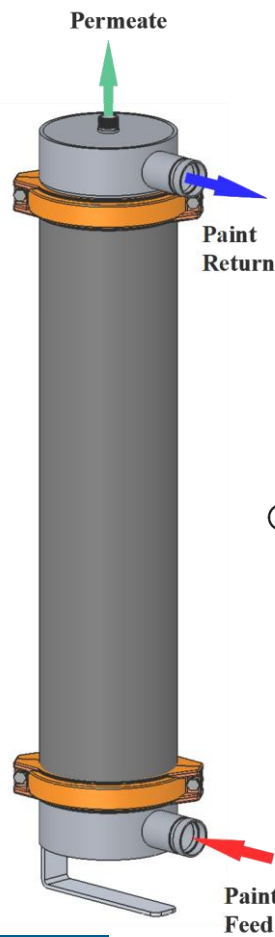
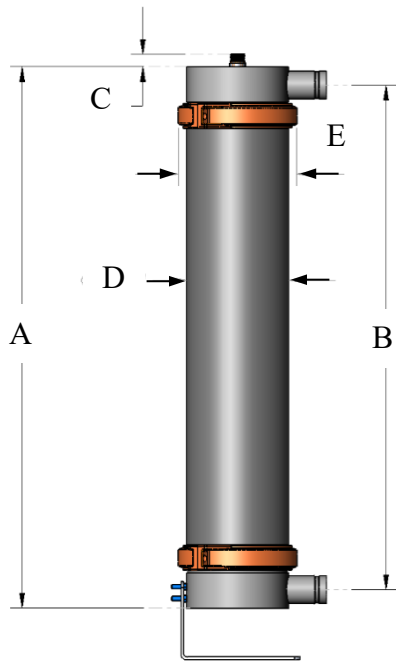

KPAK® MODULE NOMINAL DIMENSIONS:

	B	C	D	E
	45 7/8	42 3/4	1 1/4	8 5/8
	117 cm	108 cm	3 cm	22 cm

The information contained in this publication is believed to be accurate and reliable, but is not to be construed as implying any warranty or guarantee of performance. We assume no responsibility, obligation or liability for results obtained or damages incurred through the application of the information contained herein. Refer to Standard Terms and Conditions of Sale and Performance Warranty documentation for additional information

Koch Separation Solutions, Inc. 850 Main Street, Wilmington, MA 01887-3388
 Main: +1-978-694-7000 • Fax: +1-978-657-5208 • Toll Free: +1-888-677-5624

For complete contact information and listing of our global locations, visit www.kochseparation.com

©2020 Koch Separation Solutions, Inc. All rights reserved worldwide. For related trademark information, visit <https://www.kochseparation.com/legal>.